



**NOTICE OF CONSIDERATION OF
SITE PLAN PROPOSAL**

**BROTHER RICE HIGH SCHOOL
7101 LAHSER ROAD
(SIDWELL NO: 19-34-351-026)**

PLEASE TAKE NOTICE THAT a PUBLIC MEETING will be held by the Board of Trustees of the Charter Township of Bloomfield, Oakland County, Michigan on **Monday, FEBRUARY 13, 2023 at 7:00 p.m.** in the Bloomfield Township Hall Auditorium, 4200 Telegraph Road, Bloomfield Hills, MI 48302.

At the hearing, the Board will consider a site plan request for a building addition and parking lot improvements at Brother Rice High School, 7101 Lahser Road.



Comments regarding this proposal may be provided at the public hearing, submitted via email to publiccomment@bloomfieldtp.org or by contacting the Planning Division at (248) 433-7795.

NOTE: The Charter Township of Bloomfield will provide necessary, reasonable auxiliary aids and services at all meetings to individuals with disabilities. All such requests must be made at least five days prior to said meeting. Individuals with disabilities requiring auxiliary aids or services should contact Bloomfield Township by writing or calling the following: Letter • Bloomfield Township Clerk's Office, 4200 Telegraph Road, Bloomfield Hills, MI 48302. Email • clerk@bloomfieldtp.org Phone • 248-433-7702.

**MARTIN C. BROOK
BLOOMFIELD TOWNSHIP CLERK**

Post: 1-26-2023

U.S. Mail: 1-26-2023

Bloomfield Township
 CivicSight Map
 7101 Lahser Road
 89 Labels



MAP LEGEND:

- LOT LINES
- MARSH - SWAMP
- ROAD EDGE - PLANIMETRICS - 2000
- TOWNSHIP LIMITS
- SUB DIVISIONS
- RIVERS - STREAMS
- OPEN WATER
- BUILDING OUTLINE
- PONTIAC 425 AGREEMENT
- PARCEL LAYER
- NO THROUGH ROADS
- RIGHT-OF-WAY



Map Scale: 1 inch = 277 feet
 Map Date: 1/18/2023
 Data Date: January 11, 2023
 Sources: Bloomfield Township, Oakland County GIS
 Utility, River's Edge GIS, LLC.

The information provided here is intended for reference purposes only. It was compiled from a variety of available sources, with varying degrees of accuracy. Bloomfield Township assumes no responsibility for errors that arise from the use of the data.

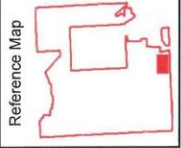
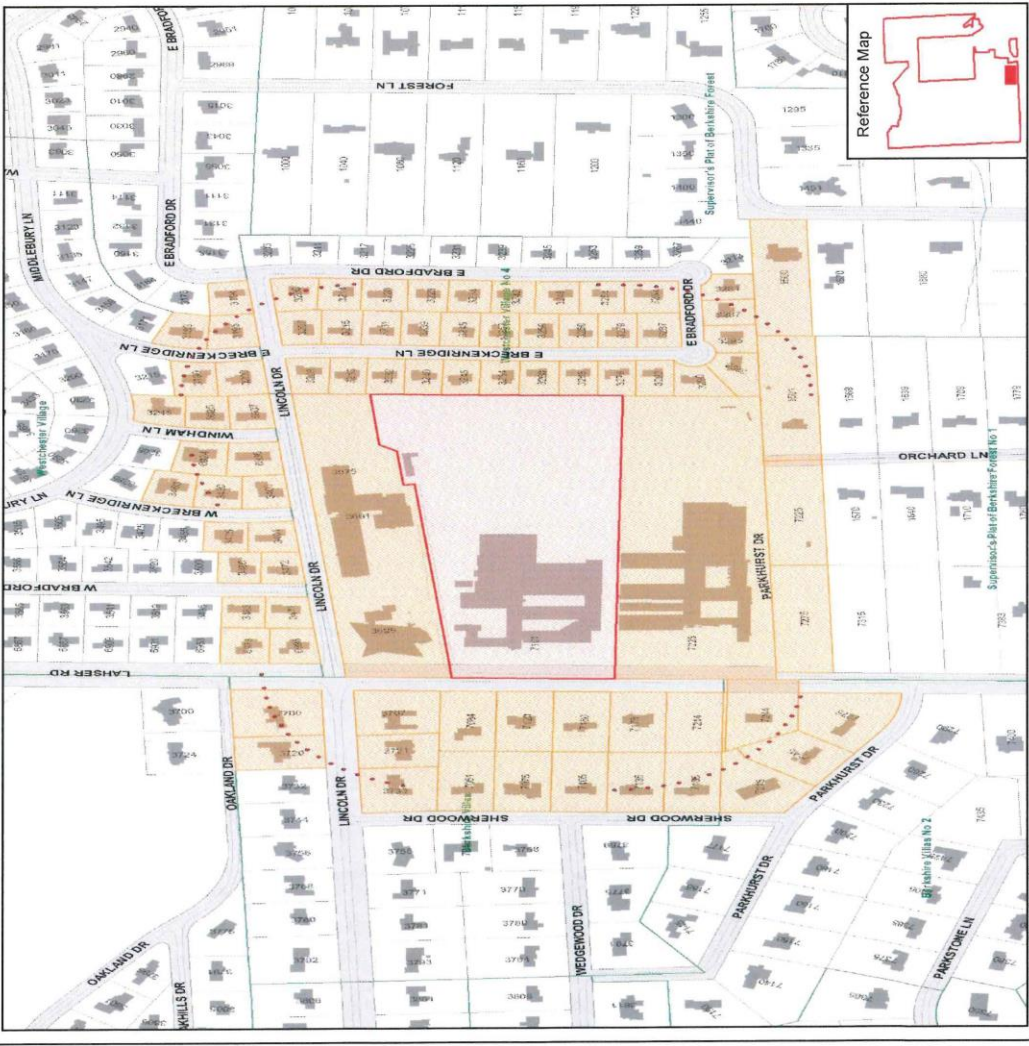

Copyright © 2009 - River's Edge GIS, LLC.